

ULTIME D Patented

metalfire

## Technical Document

ULTIME D MF 800-50 WHE 2SL V20

### Dimensions (mm)

- combustion opening WxHxD: 806x441x504
- external WxDxH: 868x600x1443
- fresh air: 2xØ150
- diameter flue: Ø250

### Technical Data

- Ecolabel: A+
- capacity: 16kW
- efficiency capacity: 82%
- CO (volume with 13%O<sub>2</sub>): 0.061%
- dust (volume with 13%O<sub>2</sub>): 23.6mg/Nm<sup>3</sup>
- weight: 320kg
- Air intake to convection: minimum 720cm<sup>2</sup>(4xØ150)
- Air exhaust to convection: minimum 720cm<sup>2</sup>(4xØ150)

### Specifications

- inside finishing: heat-resistant black paint
- vermiculite insulation plates
- convection jacket in galvanized steel
- back and sides: ribbed cast iron
- interior finishing: ORIGINAL (ribbed cast iron)

### Options

- Finishing frame

### Table: prescribed insulation thickness (mm)

Combustable finishing material				
	A	B	C	D
Test report (TC = 0,14 W/mK)	25	25	25	25
Non-combustable finishing material				
non-combustable materials (structural building items EXCLUDED e.g. load bearing walls)	0	0	0	0
TC = thermal conductivity      NC = non-combustable				

### First aid and technical support:

- support@metalfire.eu
- +32 (0)9 261 50 57

scale 1:20 Rev. A

www.metalfire.eu EN 13229 CE

General dimensional tolerances up to 6mm  
Metalfire preserves the right to modify specifications without previous notice Sheet 1/5

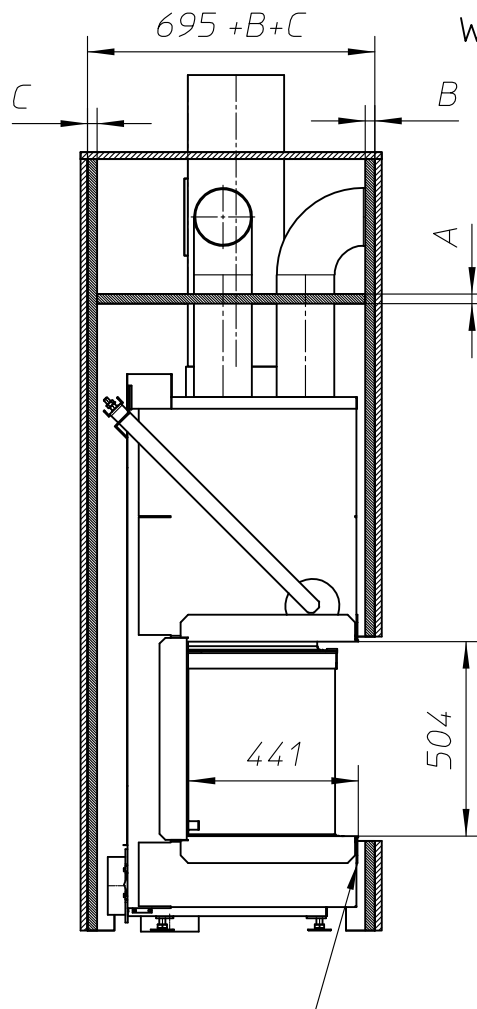
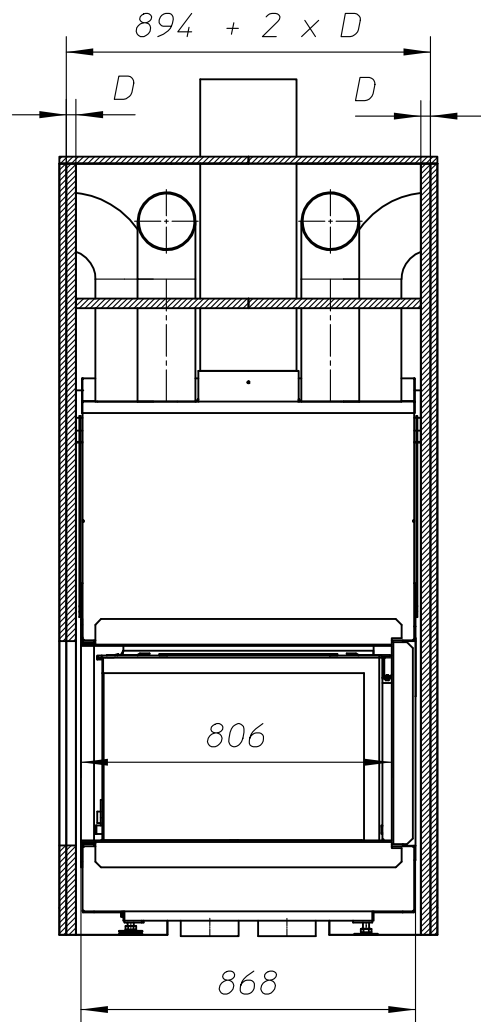

WITHOUT FINISHING FRAME

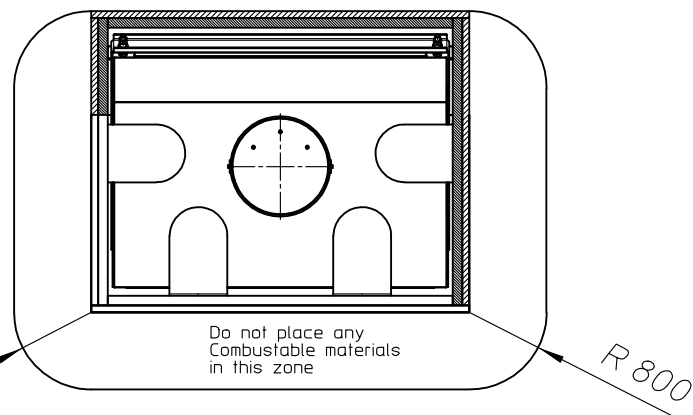

Min. 13mm between fireplace and insulation

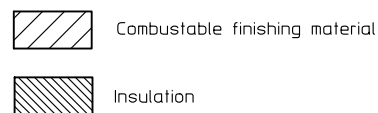

Heated convection Air 4X

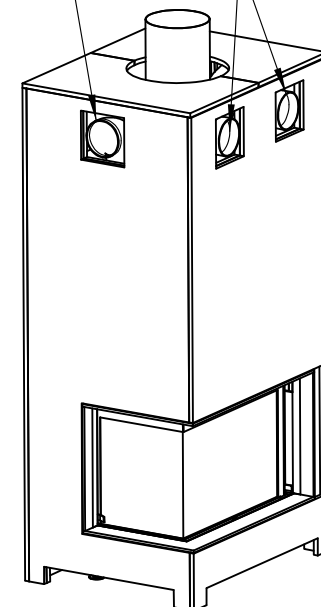

Scale 1:30

ULTIME D Patented

metalfire

## Technical Document

ULTIME D MF 800-50 WHE 2SL V20

### Dimensions (mm)

- combustion opening WxHxD: 806x441x504
- external WxDxH: 868x600x1443
- fresh air: 2xØ150
- diameter flue: Ø250

### Technical Data

- Ecolabel: A+
- capacity: 16kW
- efficiency capacity: 82%
- CO (volume with 13%O<sub>2</sub>): 0.061%
- dust (volume with 13%O<sub>2</sub>): 23.6mg/Nm<sup>3</sup>
- weight: 320kg
- Air intake to convection: minimum 720cm<sup>2</sup>(4xØ150)
- Air exhaust to convection: minimum 720cm<sup>2</sup>(4xØ150)

### Specifications

- inside finishing: heat-resistant black paint
- vermiculite insulation plates
- convection jacket in galvanized steel
- back and sides: ribbed cast iron
- interior finishing: ORIGINAL (ribbed cast iron)

### Options

- Finishing frame

### Table: prescribed insulation thickness (mm)

Combustable finishing material				
	A	B	C	D
Test report (TC = 0,14 W/mK)	25	25	25	25
Non-combustable finishing material				
non-combustable materials (structural building items EXCLUDED e.g. load bearing walls)	0	0	0	0
TC = thermal conductivity      NC = non-combustible				

### First aid and technical support:

- support@metalfire.eu
- +32 (0)9 261 50 57

scale 1:20

Rev.  
A

www.metalfire.eu

EN 13229

CE

General dimensional tolerances up to 6mm  
Metalfire preserves the right to modify specifications without previous notice

Sheet  
2/5

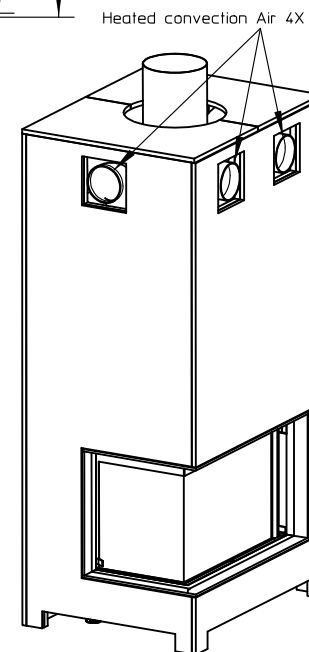
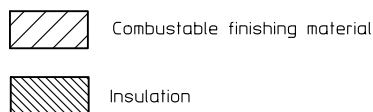
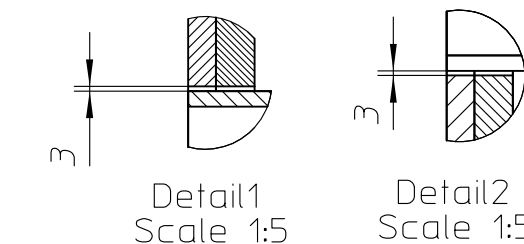
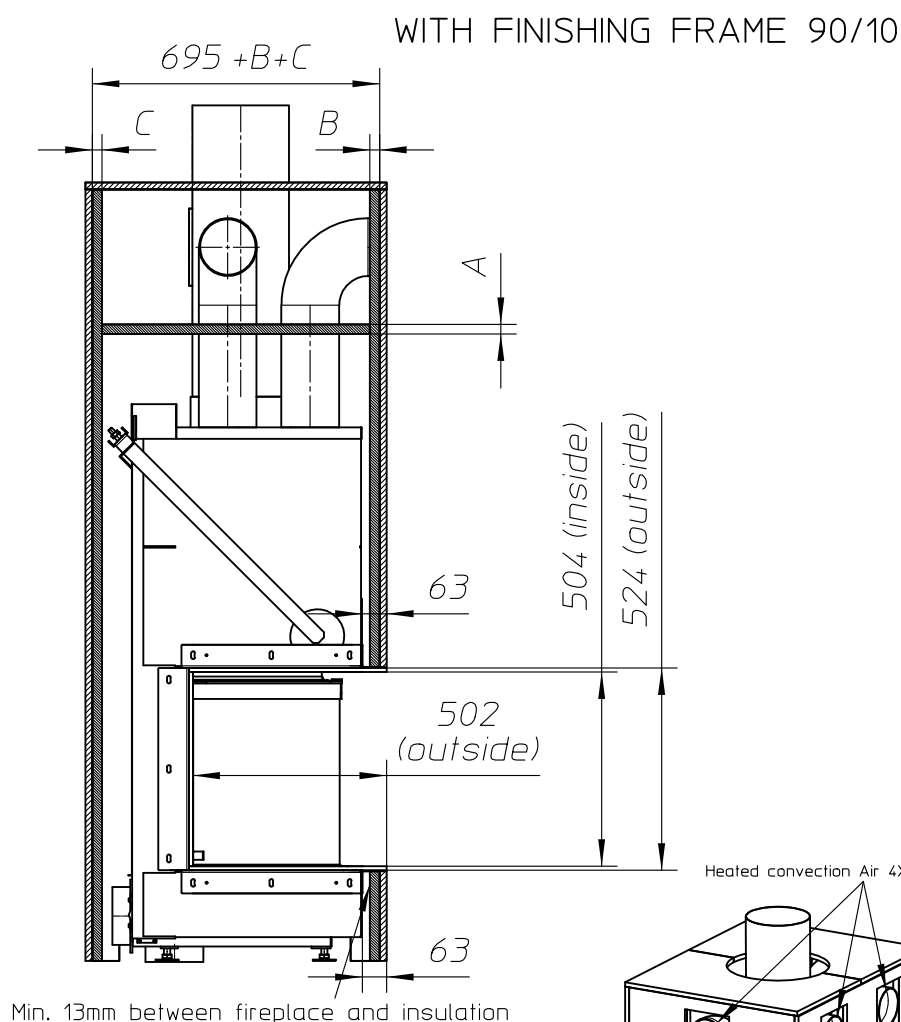
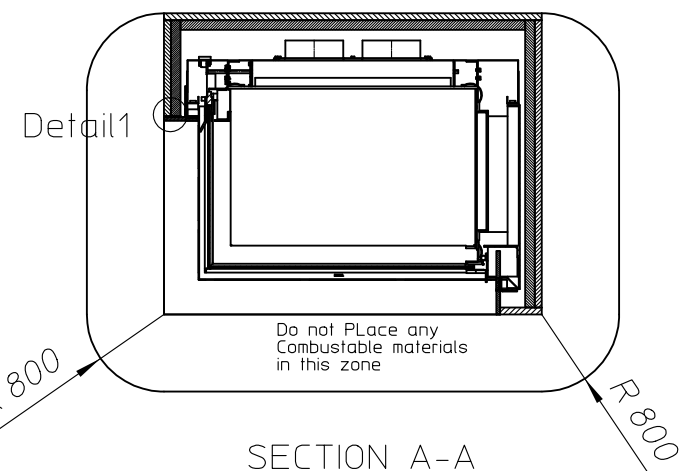
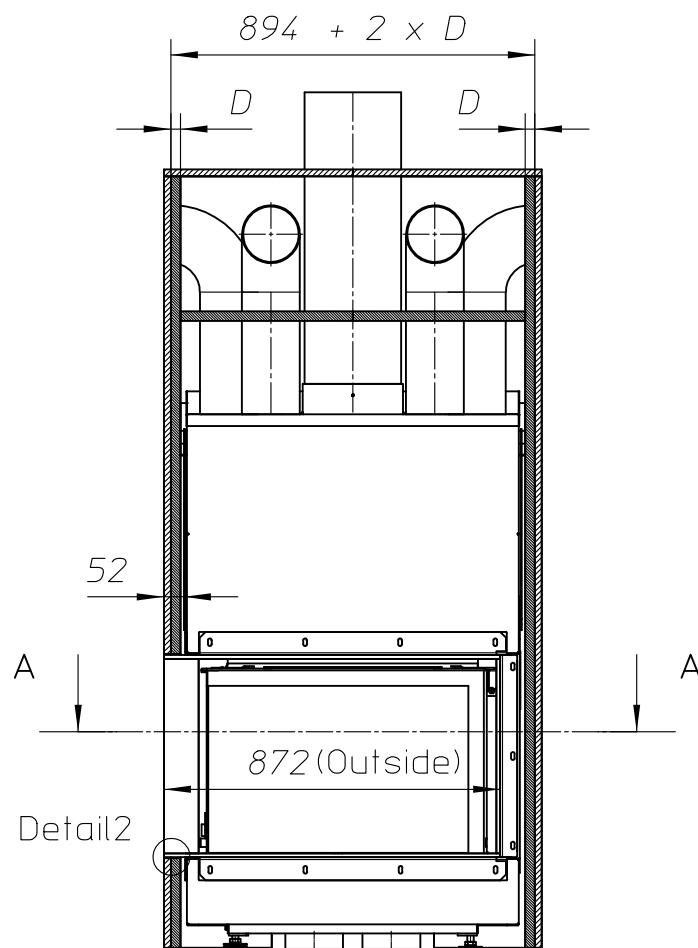

# ULTIME D Patented

## metalfire

### Technical Document

ULTIME D MF 800-50 WHE 2SL V20

#### Dimensions (mm)

- combustion opening WxHxD: 806x441x504
- external WxDxH: 868x600x1443
- fresh air: 2xØ150
- diameter flue: Ø250

#### Technical Data

- Ecolabel: A+
- capacity: 16kW
- efficiency capacity: 82%
- CO (volume with 13%O<sub>2</sub>): 0.061%
- dust (volume with 13%O<sub>2</sub>): 23.6mg/Nm<sup>3</sup>
- weight: 320kg
- Air intake to convection: minimum 720cm<sup>2</sup>(4xØ150)
- Air exhaust to convection: minimum 720cm<sup>2</sup>(4xØ150)

#### Specifications

- inside finishing: heat-resistant black paint
- vermiculite insulation plates
- convection jacket in galvanized steel
- back and sides: ribbed cast iron
- interior finishing: ORIGINAL (ribbed cast iron)

#### Options

- Finishing frame

#### Table: prescribed insulation thickness (mm)

Combustible finishing material				
	A	B	C	D
Test report (TC = 0,14 W/mK)	25	25	25	25
Non-combustible finishing material				
non-combustible materials (structural building items EXCLUDED e.g. load bearing walls)	0	0	0	0
TC = thermal conductivity NC = non-combustible				

#### First aid and technical support:

- support@metalfire.eu
- +32 (0)9 261 50 57

scale 1:20

www.metalfire.eu EN 13229

General dimensional tolerances up to 6mm  
Metalfire preserves the right to modify specifications without previous notice

Rev.  
A

CE

Sheet  
3/5

WITH FIRESCREEN - NO FINISHING FRAME

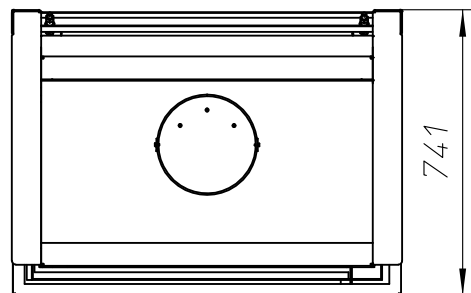
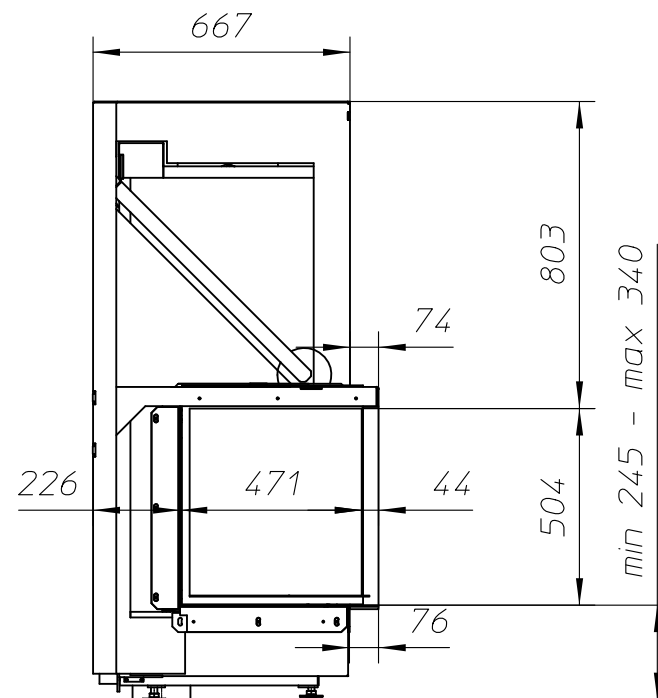
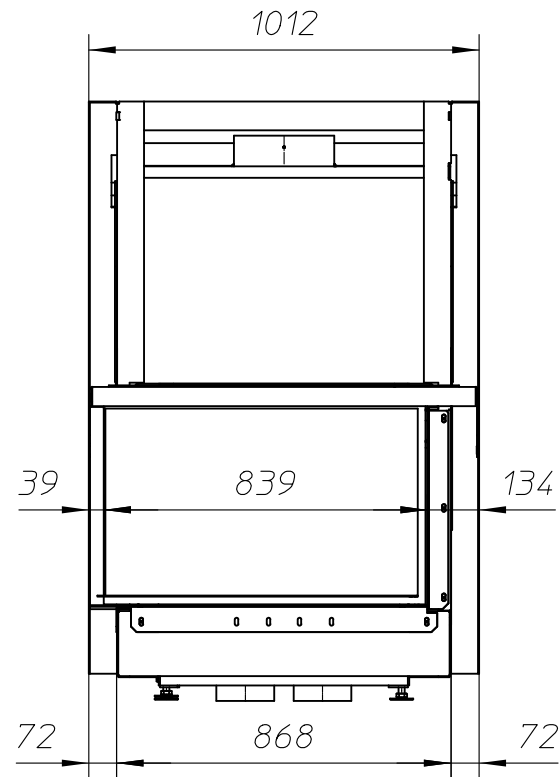

ULTIME D Patented

metalfire

## Technical Document

ULTIME D MF 800-50 WHE 2SL V20

### Dimensions (mm)

- combustion opening WxH: 868x504x441
- external WxDxH: 1012x741x1443
- fresh air: 2x $\varnothing$ 150
- diameter flue:  $\varnothing$ 250

### Technical Data

- capacity: 16kW
- efficiency capacity: 82%
- CO (volume with 13%O<sub>2</sub>): 0.061%
- dust (volume with 13%O<sub>2</sub>): 23.6mg/Nm<sup>3</sup>
- weight: 320kg
- Air intake to convection: minimum 720cm<sup>2</sup>(4x $\varnothing$ 150)
- Air exhaust to convection: minimum 720cm<sup>2</sup>(4x $\varnothing$ 150)

### Specifications

- inside finishing: heat-resistant black paint
- vermiculite insulation plates
- convection jacket in galvanized steel

First aid and technical support:

- support@metalfire.eu
- +32 (0)9 261 50 57

scale 1:20

Rev.  
A

www.metalfire.eu EN 13229

CE

General dimensional tolerances up to 6mm  
Metalfire preserves the right to modify specifications without previous notice

Sheet  
4/5

ULTIME D MF 800-50 WHE 2SL V20

#### Dimensions (mm)

- combustion opening WxH: 868x441x504
- external WxDxH: 1120x798x1443
- fresh air: 2x $\varnothing$ 150
- diameter flue:  $\varnothing$ 250

#### Technical Data

- capacity: 16kW
- efficiency capacity: 82%
- CO (volume with 13%O<sub>2</sub>): 0.061%
- dust (volume with 13%O<sub>2</sub>): 23.6mg/Nm<sup>3</sup>
- weight: 320kg
- Air intake to convection: minimum 720cm<sup>2</sup> (4x $\varnothing$ 150)
- Air exhaust to convection: minimum 720cm<sup>2</sup> (4x $\varnothing$ 150)

#### Specifications

- inside finishing: heat-resistant black paint
- vermiculite insulation plates
- convection jacket in galvanized steel

First aid and technical support:

- support@metalfire.eu
- +32 (0)9 261 50 57

scale 1:20

Rev.  
A

www.metalfire.eu EN 13229

CE

General dimensional tolerances up to 6mm  
Metalfire preserves the right to modify specifications without previous notice

Sheet  
5/5

